



# Systeme Demonte **Pai**<sup>®</sup>

## AVANTAGE

**DANS LE TRANSPORT ET LA MANUTENTION**

*ADVANTAGE IN TRANSPORTATION AND HANDLING*



SYSTEME DEMONTE PAL  
PAL DEMONTE SYSTEM

**656**

QUANTITE FENÊTRE  
QUANTITY WINDOW



SYSTÈME CLASSIQUE  
CLASSICAL SYSTEM

**197**

QUANTITE FENÊTRE  
QUANTITY WINDOW





# Systeme Demonte **Pai**<sup>®</sup>

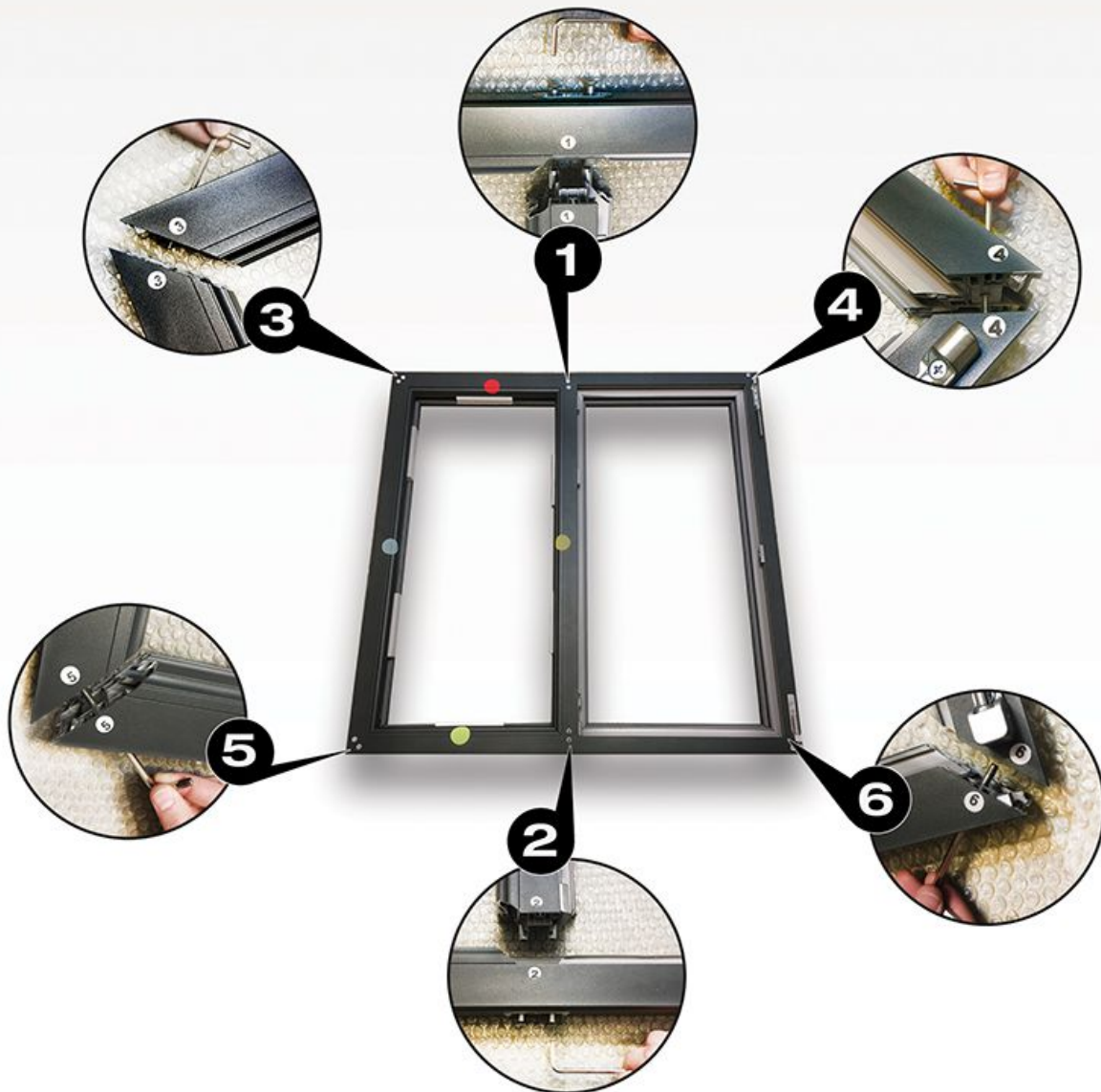

**SCHÉMA D'INSTALLATION DU CHASSIS**  
*FRAME INSTALLATION DIAGRAM*



# Systeme Demonte **Pai**<sup>®</sup>

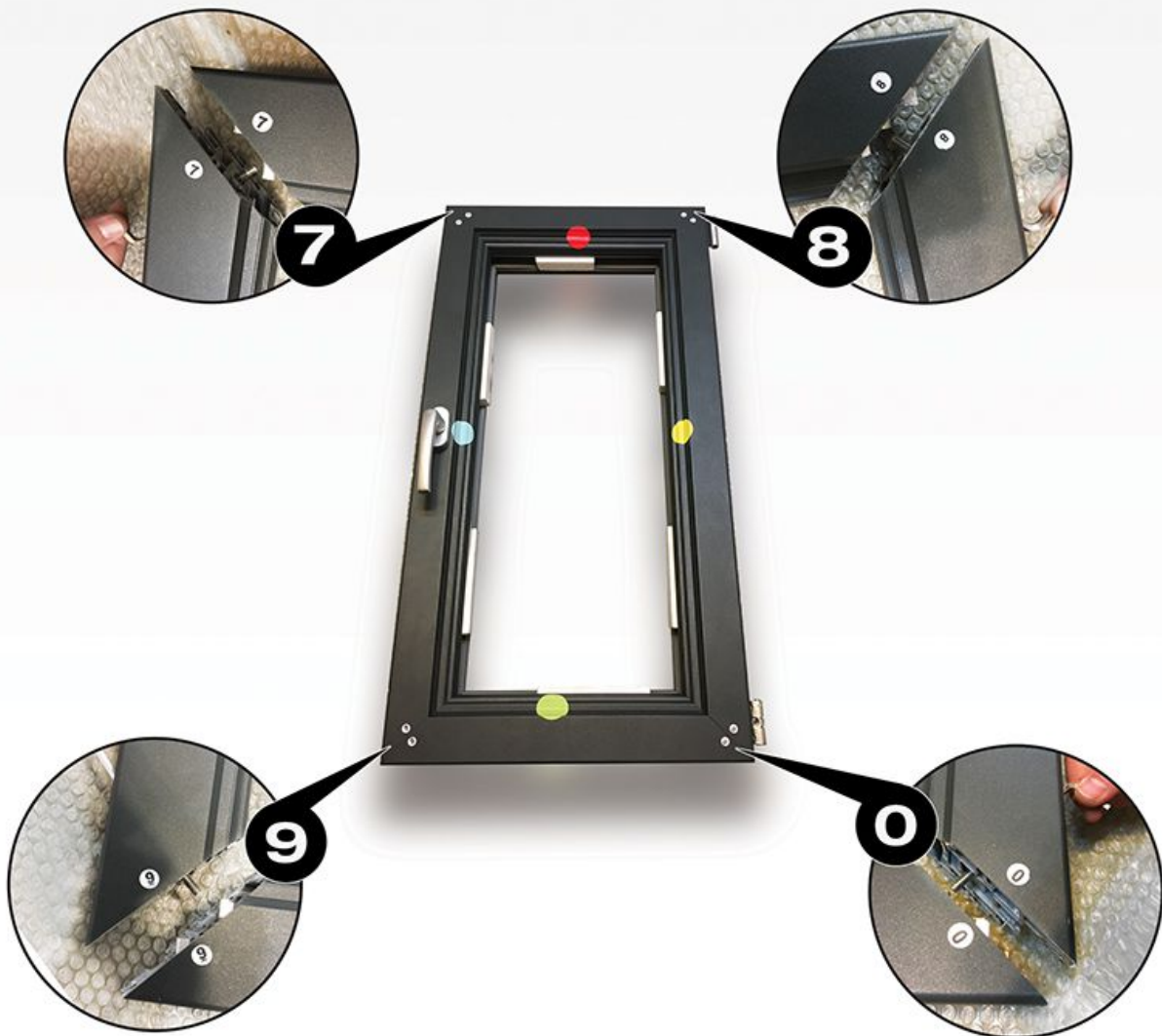

**SCHÉMA D'INSTALLATION DE BATTANTS**  
*SASH INSTALLATION DIAGRAM*





# Systeme Demonte **Pai**<sup>®</sup>

## PORTES ET FENÊTRES DEMONTABLE DU SYSTEME PAL

*PAL SYSTEM DEMOUNTED DOOR & WINDOW SYSTEMS*





# RÉSULTATS D'ÉPREUVES

## TEST RESULTS

**PfB** Prüfzentrum für Bauelemente  
Dipl.-Ing. (FH) Rüdiger Müller

Fenster · windows  
Rollläden · shutters  
Türen + Tore · doors  
Fassaden · curtain walling  
Baubeschläge · building hardware

Test Certificate NR. 16/11-A001-Z1

Version 1.en

Thermal transmittance of frames  $U_f$  calculated according to DIN EN ISO 10077-2: 2012-06 "Thermal performance of windows, doors and shutters - Calculation of thermal transmittance - Part 2: Numerical method for frames (ISO/DIS 10077-2: 2003) German version EN ISO 10077-2: 2012"

**Applicant** Ersay Yapı Taah.San.Tic.Ltd.Şti  
Topçular Mah.Incirlık Cad. No:18  
Eyüp - İstanbul  
Turkey

**Product type** PVC profile with Aluminium cover

**Product Designation** PAL System

**Dimensions**  
Frame (w x h) approx. 60 x 56 mm  
Casement (w x h) approx. 79 x 79 mm  
Transom (w x h) approx. 60 x 78 mm  
Aluminium cover thickness 1,2 mm.



**Sealing** TPE

**Test Report** Test Report No. 16/11-A001-Z1 from December 01, 2016

**Results** DIN EN ISO 10077-2 Thermal Transmittance  $U_f$

Profile types	$U_f$ [W/m²K]
Frame	1,7
Frame and Casement	1,5
Transom and Casement	1,6

**Validity** Period of validity of DIN EN ISO 10077-2: 2012-06

Dipl.-Ing. (FH) Rüdiger Müller  
Head of Institute

Stephanskirchen  
December 01, 2016

Yigit Altug  
Responsible Official

PfB GmbH & Co. Prüfzentrum für Bauelemente KG  
AG Traunstein 18A 8871  
Lackmanring 24, 83071 Stephanskirchen  
gHC PfB Verwaltungsgesellschaft  
Geschäftsführer: Matthias Demmel, Rüdiger Müller  
AG Traunstein HRB 16490

Teléfono +49 (0) 80 36 / 674947-0  
Telefax +49 (0) 80 36 / 674947-28  
www.pfb-rosenheim.de  
info@pfb-rosenheim.de

Sparkasse Rosenheim-Bad Aibling  
IBAN: DE88 7115 0000 0500 5567 41  
SWIFT-BIC: BYLADE33HAN33  
Steuer-Nr.: 156/122/33009  
USt-IdNr.: DE245335602

Anerkennung Prüfverfahren  
Landesbeurkundung  
TAF 33  
Notified Body  
No. 1044



### TEST RESULTS

The calculation results for Thermal Transmittance ( $U_f$ ,  $U_{f,w}$ ) values, calculated according to the standards EN ISO 10077-2 "Thermal performance of windows, doors and shutters: Calculation of thermal transmittance Part 2: Numerical method for frames" and EN ISO 10077-1 "Thermal performance of windows, doors and shutters Calculation of thermal transmittance Part 1: Simplified method", are given in Table 3 and Table 4 respectively.

Table 3. Thermal Transmittance Values of Individual Frame Sections

Section	Transmittance, $U_f$ (Calculated, W/m²K)	Transmittance, $U_f$ (Rounded, W/m²K)
01	1,6366	1,6
02	1,5316	1,5
03	1,6325	1,6

Table 4. Thermal Transmittance Value of the Window Element

Product	Transmittance, $U_{f,w}$ (Calculated, W/m²K)	Transmittance, $U_{f,w}$ (Rounded, W/m²K)
PAL Window System ( $U_g = 1,1$ W/m²K)	1,3865	1,4

Z. Z.



**Pal System**  
Plastic & Aluminum

MENUISIERIE EN  
**ALUMINIUM**  
AVEC UNE  
ISOLATION EN PVC

**PVC INSULATED ALUMINUM JOINERY**



**FENÊTRE** FABRIQUEE A PARTIR DU PROFILE COMPOSITE  
*WINDOWS CRAFTED FROM COMPOSITE PROFILE*



**Transmission de la chaleur**

*Thermal transmittance*

**$U_f W/(m^2 K) = 1,5$**



**Transmission de la chaleur**

*Thermal transmittance*

**$U_f W/(m^2 K) = 1,5$**

**Pal System**  
Plastic & Aluminum

**Ersas Alüminyum A.Ş. Head Quarters**

Ersas İş Merkezi, İncirlik Sk. No:18 PK 34050  
Eyüp / İstanbul / Turkey  
Tel: +90 (212) 674 84 84 (Pbx)  
Fax: +90 (212) 501 95 76  
ersas@ersasaluminyum.com.tr  
export@ersasaluminyum.com.tr  
www.ersasaluminyum.com.tr

**Bureau de vente en FRANCE**

Adresse : 03 Route Romaine 67700 SAVERNE  
Bureau : (+33) 09.50.88.00.78  
francebureau@ersasaluminyum.com.tr  
www.ersasaluminyum.com.tr